



16, The Meads Green Lane, Windsor, SL4 3TP
£125,000

 **HORLER**

16, The Meads Green Lane, Windsor, SL4 3TP

Welcome to this recently decorated and charming retirement property located in the heart of Green Lane, Windsor. This delightful flat is perfect for those over 60 who are looking for a peaceful and convenient place to call home.

Situated in The Meads, this property offers easy access to all local amenities, making daily errands a breeze. The flat boasts a dual aspect spacious living/dining room, ideal for relaxing or entertaining guests. The fully fitted kitchen provides a perfect space for whipping up delicious meals.

With one bedroom and one bathroom, this apartment is cosy yet comfortable, offering a tranquil retreat for its residents. The apartment is located on the south side of the development offering unrivaled views and natural light

Whether you're looking to downsize or simply enjoy the benefits of retirement living, this property is sure to meet your needs.

Don't miss out on the opportunity to own this lovely flat in a sought-after retirement community. Book a viewing today and envision yourself enjoying the peaceful lifestyle that The Mead has to offer.



PROPERTY SUMMARY

One bedroom over 60's retirement apartment.

With communal lounge, laundry room, well maintained garden, private parking and house manager 'on call'

Large living/dining room, fitted compact kitchen and shower room.

Close to local amenities, shops and transport links.

GENERAL INFORMATION

Lease: 92 yrs remaining

Service Charge £2080.00 for 6 months

Ground Rent £285.00 for 2 months

Council Tax Band 'D'

LEGAL NOTE

Although these particulars are thought to be materially correct their accuracy cannot be guaranteed and they do not form part of any contract.





Fire exit

27

Fire alarm

No smoking

In the event of a fire, pull the alarm

6

Total Approximate Floor Area

538 Square feet

50 Square metres

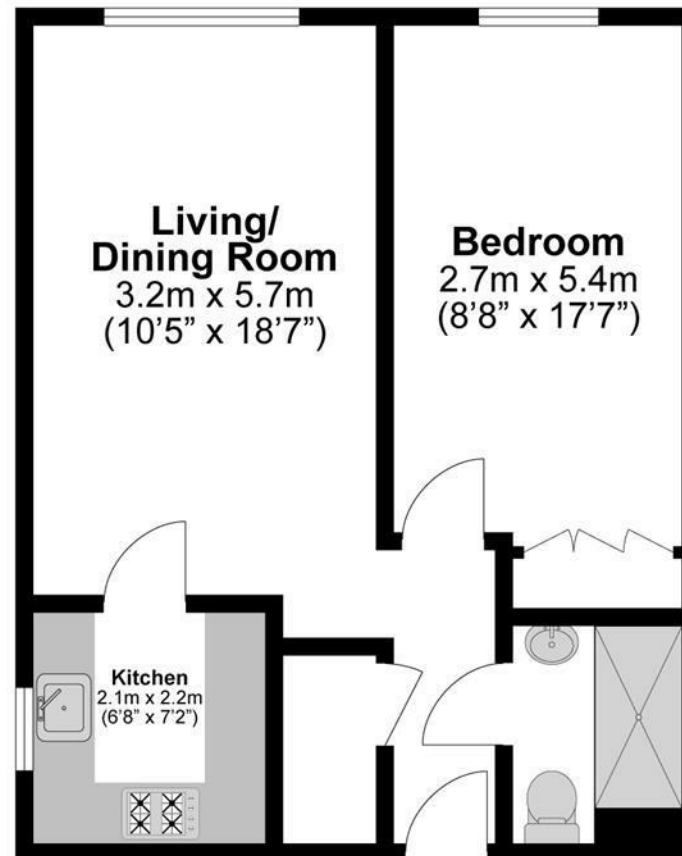

**Illustrations are for identification purposes only,
measurements are approximate, not to scale.**